

## Quartztone® Undermount 70/30 Double Bowl Model S-175U



S-175U

### FEATURES

- 80% quartz
- 7-1/4" and 9" depth
- Inherently hygienic Non-porous surface
- Natural, antibacterial hygiene protection system
- Silky to the touch, 3 times harder than natural granite
- Food-safe, UV-stable-will not fade
- Heat resistance to +500°F
- Highest resistance to thermal shock, scratches and chips
- Color-fast throughout
- Fits 36" sink base • cUPC listed
- Supplied with cutout template, fasteners and instructions
- 1 year Limited Warranty

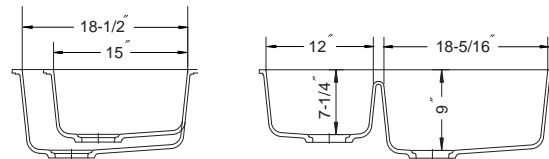
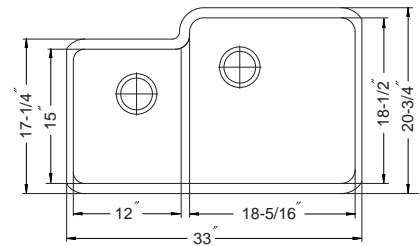

### OPTIONAL COLORS



**Midnite**  
Metallic

**Mocha**  
Solid

**Earth**  
Structured

**Sand**  
Solid

**Cloud**  
Solid

OVERALL DIMENSIONS	EACH BOWL	CUTOUT SIZE	PACKAGING*	WEIGHT*
33" x 20-3/4"	12" x 15" 18-5/16" x 18-1/2"	See Template	1/10 pcs.	49/530lbs.

\*Standard packaging: Single boxed /Pallet of single boxed.  
All dimensions are in inches. Specifications subject to change without notice.

### OPTIONAL ACCESSORIES

Bottom Grid: 629711(left), 629712(right)  
Strainer Options: Stainless steel strainers,  
Color strainers, Color Disposal flanges

Project/Job name \_\_\_\_\_

Architect/Engineer \_\_\_\_\_

Contractor \_\_\_\_\_

Model \_\_\_\_\_ Q'ty \_\_\_\_\_

Notes \_\_\_\_\_