

SCHOCK ◀ HOUZER Undermount Single Bowl Model Gemo N-100U

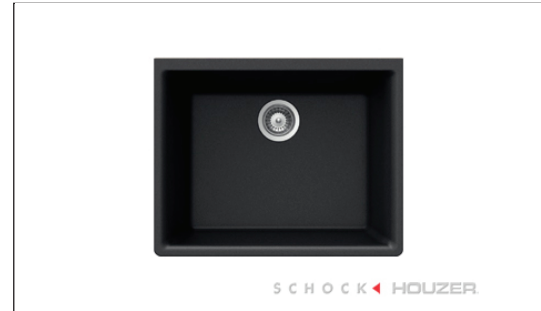

Gemo N-100U

FEATURES

- CRISTALITE+®
- 8-11/16" depth
- Intrinsically hygienic Non-porous surface
- Antibacterial protection with silver ion Antibac®
- Silky to the touch, 3 times harder than natural granite
- Food-safe, UV-stable-will not fade
- Heat resistance to +500°F
- Highest resistance to thermal shock, scratches and chips
- Color-fast throughout
- Fits 30" sink base • cUPC listed
- Supplied with cutout template, fasteners and instructions
- Lifetime Limited Warranty

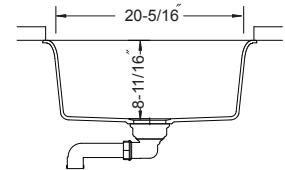
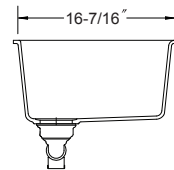
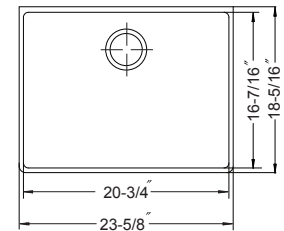

OPTIONAL COLORS

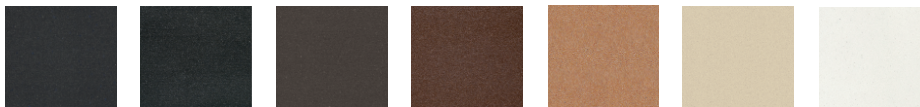

Nero Solid

Onyx Metallic

Mocha Solid

Copper Structured

Cayenne Metallic

Colorado Solid

Alpina Solid

| OVERALL DIMENSIONS | EACH BOWL | CUTOUT SIZE | PACKAGING* | WEIGHT* |
|--------------------|--------------------|--------------|------------|------------|
| 23-5/8" x 18-5/16" | 20-3/4" x 16-7/16" | See Template | 1/10 pcs. | 33/370lbs. |

*Standard packaging: Single boxed /Pallet of single boxed.
All dimensions are in inches. Specifications subject to change without notice.

OPTIONAL ACCESSORIES

Bottom Grid: 629704

Cutting Board : CB-4100

Wire Tray: WT-3500

Strainer Options: Stainless steel strainers,
Color strainers, Color Disposal flanges

Project/Job name

Architect/Engineer

Contractor

Model

Q'ty

Notes