

## MEDALLION GOURMET SERIES

### Undermount 60/40 Gourmet Double Bowl Model MES-3221



MES-3221

#### FEATURES

- Premium grade T-304 stainless steel
- 10" & 8" depth • 16 gauge
- StoneGuard™ undercoating over Super-Silencer pad
- Lustrous satin with highlighted rim
- Fits 36" sink base • 3-1/2" drain opening
- Supplied with cutout template, fasteners and instructions
- cUPC® Listed
- Lifetime Limited Warranty



**TYPE 304**  
PREMIUM STAINLESS STEEL

**SUPER  
SILENCER**

**StoneGuard™**  
UNDERCOAT PROTECTION

**Lifetime  
Warranty**

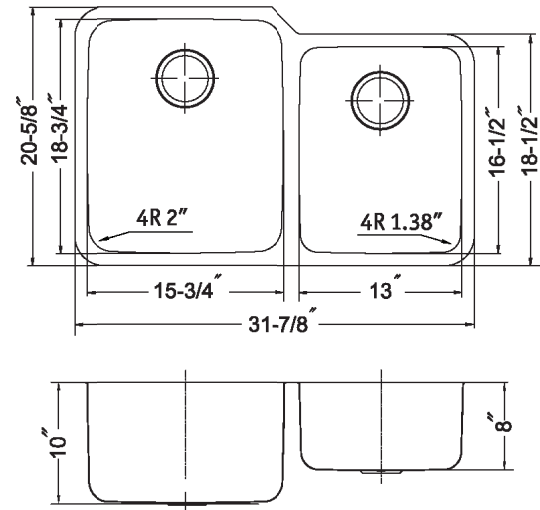

#### OPTIONAL ACCESSORIES

Bottom Grid: BG-3500

Strainer: 190-9180

OVERALL DIMENSIONS	EACH BOWL	CUTOUT SIZE	PACKAGING*	WEIGHT*
31-7/8" x 20-5/8"	15-3/4" x 18-3/4" 13" x 16-1/2"	See Template	1/16/20 pcs.	28/480/500 lbs.

\*Standard packaging: Single boxed /Pallet of single boxed/Pallet of bulk pack.  
All dimensions are in inches. Specifications subject to change without notice.

Project/Job name

Architect/Engineer

Contractor

Model

Q'ty

Notes

#### Installation profile

