

Hammerwerks Series

Hand-Hammered Copper and Pewter Sinks

Round Vessel Sink with Apron

Model **HW-DUJOUR15A**
HW-DUJOUR15S



FEATURES

- Round vessel sink with apron
- 15" OD
- 5-1/4" depth
- 1-1/2" drain opening

Model information

- **HW-DUJOUR15A** Round Sink with Apron, Antique copper w/ overflow
- **HW-DUJOUR15S** Round Sink with Apron, Lustrous pewter w/ overflow

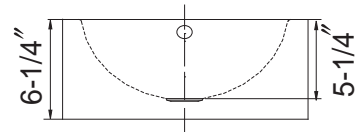
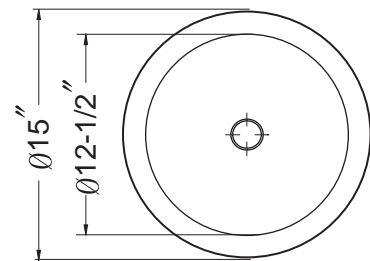

Installation information

Your Hammerwerks® Hand-Hammered Copper sink is individually hand-crafted and not the product of assembly-line specifications. Every sink is unique and therefore a variance of approximately 1/4" in dimensions is usual. We recommend receiving your specific sink and measuring before cutting your countertop to ensure proper fit.

OVERALL DIMENSIONS	EACH BOWL	CUTOUT SIZE	PACKAGING*	WEIGHT*
Ø15"	Ø12-1/2"		1/16 pcs.	14/264 lbs.

*Standard packaging: Single boxed /Pallet of single boxed.

All dimensions are in inches. Specifications subject to change without notice.

Project/Job name _____

Architect/Engineer _____

Contractor _____

Model _____ Q'ty _____

Notes _____